

August 12, 2011

CONTACT: Marcia McAllister

T: 703-572-0506

C: 571-730-9117

marcia.mcallister@dullesmetro.com

REMINDER: Lane Shifts of Eastbound Leesburg Pike (Route 7) at Dulles Toll Road Interchange Scheduled for TONIGHT, Friday Night, Aug. 12

Dulles Corridor Metrorail Project construction crews are scheduled to implement a shift of the eastbound lanes of Leesburg Pike (Route 7) between the Dulles Toll Road (Route 267) overpass and Tyco Road/Westwood Center Drive in the overnight hours Friday night, Aug. 12.

The lanes will shift to the left to allow for room to construct a concrete structure called a "straddle bent" that will straddle two piers over eastbound Route 7. This is part of the bridge flyover (or "guideway") that will carry future Metro tracks between Route 7 and the DIAAH median.

The lane shift will occur just after the Dulles Toll Road (Route 267) bridge. The two thru lanes will shift to the left toward the median for about a 700-foot distance then shift back to the right before Tyco Road/Westwood Center Drive (*see map*).

Tonight only: While the lane shift is implemented in the overnight hours, the left-turn lane from eastbound Route 7 to Tyco Road will be closed. Detour by staying on Route 7 east, then U-turning at Spring Hill Road to turn right on to northbound Tyco Road.

Traffic exiting from the eastbound Dulles International Airport Access Highway (DIAAH) will continue to use the appropriate westbound or eastbound ramps on to Route 7. However, motorists should expect the ramp to westbound Route 7 to be narrowed to one lane.

Note: Tysons Connector buses using this ramp to turn right and access eastbound Route 7 to Tyco Road will still be able to use this ramp.

This lane shift is expected to be in place through May 2012.

Motorists are urged to use extreme caution, and pay attention to signage when traveling through this area. Police will be on site. All work is weather-dependent and subject to change.

SEE MAP BELOW

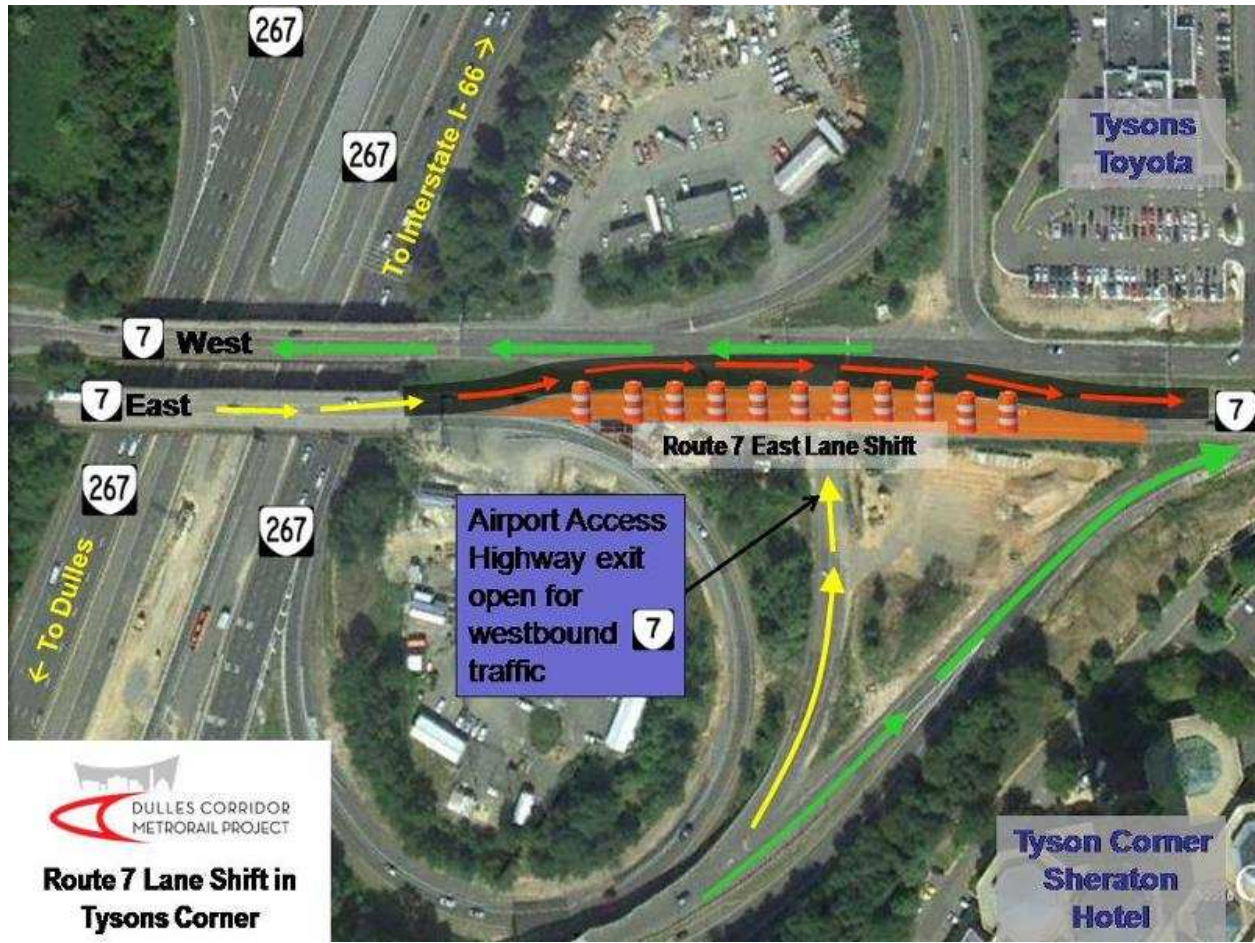

A 24/7 emergency hotline is available for construction-related issues: 877-585-6789.
For general project information: www.dullesmetro.com or 703-572-0506.